WATER CONNECTION 3/4" GAS

DRAINING Ø 24mm

ELECTRICAL SUPPLY
TECHNICAL DATA
EXTERNAL DIMENSIONS
width 600 mm

depth 610 mm

height 850 mm

WEIGHT 63.5 kg

VOLTAGE 400V 3N 50Hz (380/400V 3 60Hz "Marina")

POWER REQUIRED 5150 W

WATER HARDNESS 2-8 °f

INLET WATER PRESSURE 200-400 kPa

CROCKERY DIMENSIONS
plates diameter 340 mm

dishes max. height 325 mm/GASTRONORM

RACK DIMENSION 500X500 mm

RACK EQUIPMENT 1XC40 - 1XC44 - 1X15060

WASHING CYCLES (sec) 1 (60) 2 (90) 3 (120) 4 (180)

WATER SUPPLY 55°C
racks/h(*)(1) 60 40 30 20

WATER SUPPLY 10°C
racks/h(*)(1) 24 20 20 20

WATER CONSUMPTION / CYCLE 2.3 l

(water pressure 200kPa)
BOILER CAPACITY 5.7 l

BOILER HEATING ELEMENT 4500 W

RINSING TEMPERATURE (SET) 70°C 85°C

TANK CAPACITY 16.5 l

TANK HEATING ELEMENT 2700 W (2230W "Marina")

TANK TEMPERATURE (SET) 55°C

PUMP POWER 650 W (340 l/min***)

DRAIN PUMP (optional) 25 W h MAX draining 0.8 m (40 l/min***)

NOISE 61,3±0.7 dB(A)

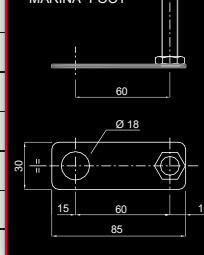
PIEDINO "MARINA" "MARINA" FOOT

PIEDINO "MARINA" "MARINA" FOOT

(*) In case of cold water supply and/or continuous washing, the rinse-water heating process might take more time than usual, until the proper rinse temperature is reached. For this reason, the wash-cycle total timing might result longer than set.